

EC LIVING
BY ELECTROCOMPANIE

**WIRELESS AND MODULAR
AUDIO SYSTEM**



SCANDINAVIAN DESIGN

EC Living is pure Scandinavian design and engineering. Designed, built and produced in Norway.

The signature combination of cloth, wood and metal gives it a timeless quality. It is inspired by Norway's beautiful landscapes and rich heritage. Every system is produced at our state-of-the-art facilities, and producing the entire system right here in Norway, ensures the highest standards of quality. All Electrocompaniet's knowledge is put into the EC Living system. The way we listen to music may change, but our dedication to quality remains.

Your style

Style is personal. Every EC Living product can be customized to suit you. There are many different colors and finishes to choose from. Classic matte black, white and copper, matte chrome or even hand-crafted wood. If your tastes change, you can always change your mind later. Why not redecorate your HiFi when you redecorate your room?

New features and products in the EC Living series will be continually available. Check our website for the latest list.



TANA SL-1



Wireless Speaker & Streamer

The TANA SL-1 is an all-in-one solution. A wireless loudspeaker, an amplifier and audio streamer. It can play music from your collection or files off the internet. Control is easy, either via an app or a web browser. On its own it is a perfect companion to bring music to the bedroom, kitchen, the home office or living room.

Combine it with the active loudspeaker TANA L-1 to create a wireless HiFi stereo. You will be amazed by the big, natural and exquisite sound this small system produces.



Choose from the wide range of colors and finishes to customize your design.



TANA L-1



Wireless Add-on Speaker

The TANA L-1 is an add-on wireless loudspeaker to be used to enhance the other models, and create a HiFi or home cinema system.

It is not just a loudspeaker. It is the result of mixing timeless Scandinavian design with forty years of experience and technology - in pursuit of perfect music reproduction. It is staying true to our principles and philosophies. Where many other compact systems use electronic Class-D amplifiers and simple equalizers, we incorporate analog Class-AB amplifiers and sophisticated signal processing. Because in the end, music really matters.



Choose from the wide range of colors and finishes to customize your design.



RENA S-1

S WIRELESS AUDIO STREAMER

The RENA S-1 is a simple solution for upgrading your system with next-generation audio streaming. It provides a way to connect directly to your existing amplifier, whilst still having the possibility of adding wireless speakers later.

All this makes the RENA S-1 the most affordable and future-proof way to enter the realm of EC Living. This add-on solution is an easy start and can grow and expand in the direction that you want it to. Add a SIRA L-1 subwoofer to upgrade your system, adding more punch. Or add the TANA L-1 add-on speaker for more channels. Why not replace your existing system and get rid of the cables?

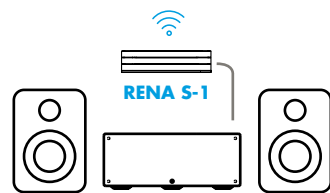

YOUR EXISTING AUDIO SYSTEM



TANA L-1 RENA S-1 TANA L-1



Choose from the wide range of colors and finishes to customize your design.

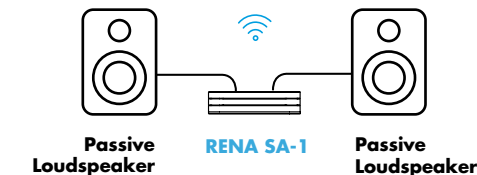

RENA SA-1

S WIRELESS AUDIO STREAMER

A 2x75W STEREO AMPLIFIER

The RENA SA-1 is both a streamer and a compact but powerful digital amplifier for upgrading your existing loudspeaker system with next-generation audio streaming. It connects directly to your existing loudspeakers, and can easily drive even the biggest loads.

The RENA SA-1 is the ideal product for those who want to replace their big and old stereo with a sleek and compact solution. Or for those who want to keep using their passive speakers, but need a compact solution with streaming. You can even add a SIRA L-1 subwoofer, upgrading your system with added punch.



Choose from the wide range of colors and finishes to customize your design.





SIRA L-1

Wireless Subwoofer

Use the SIRA L-1 to upgrade a system, adding even more weight and presence. Even though this model has all the power of big subwoofers, it is compact in size. It can either stand pretty or be hidden under a couch, shelf, etc. Like every other EC Living speaker model, it is totally wireless. That way, you can feel and hear the added weight of bass drums, not noticing the sub.

Adding one (or even more) SIRA L-1 to a system lets you play your music deeper, louder and tighter. The system automatically recognizes it, and will adjust all speakers to match perfectly. Adding a Sira L-1 adds tremendous quality to all of the EC Living system.



Choose from the wide range of colors to customize your design.



EC LIVING IS EASY TO CONTROL

All the streamers in the EC Living series can be controlled from any tablet, smartphone, PC/Mac, or by the system itself. Our free app for iPhone, iPad and Android devices offers easy access to all features and settings of the system. It allows you to command your system, set it up and control it. All streamers are also compatible with Spotify Connect, allowing

you to transfer playback straight from your phone, tablet or Mac to the system. Alternatively, you can also use any UPnP compatible app to control the playback of the system. All the streamers offer an intuitive web-interface. This allows you to configure and control the unit without installing any additional software or worrying about compatibility.



Made for

iPod iPhone iPad



TIDAL



ENJOY MUSIC WIRELESSLY THROUGHOUT YOUR HOUSE

EC Living offers a simple way to bring HiFi, music and film into the whole house. By combining different products, you can build everything from a small kitchen radio to a big home cinema.

Here's how it works.

Select a streamer unit and connect it to your existing network via ethernet cable or wireless lan. There are many types of streamer units, to suit your needs. Some are all-in-one units with loudspeakers, others can connect to your existing equipment.

Now, companion speakers can be added. These are wireless, and will automatically connect to the streamer.

With these, one can add speakers to create stereo, or even surround up to 7.4 channels *(will be available later).

Streamers can be added to bring sound to all rooms. Just like the first streamer, connect them to your network by cable or wifi. They can all very easily be controlled with the EC Living app.

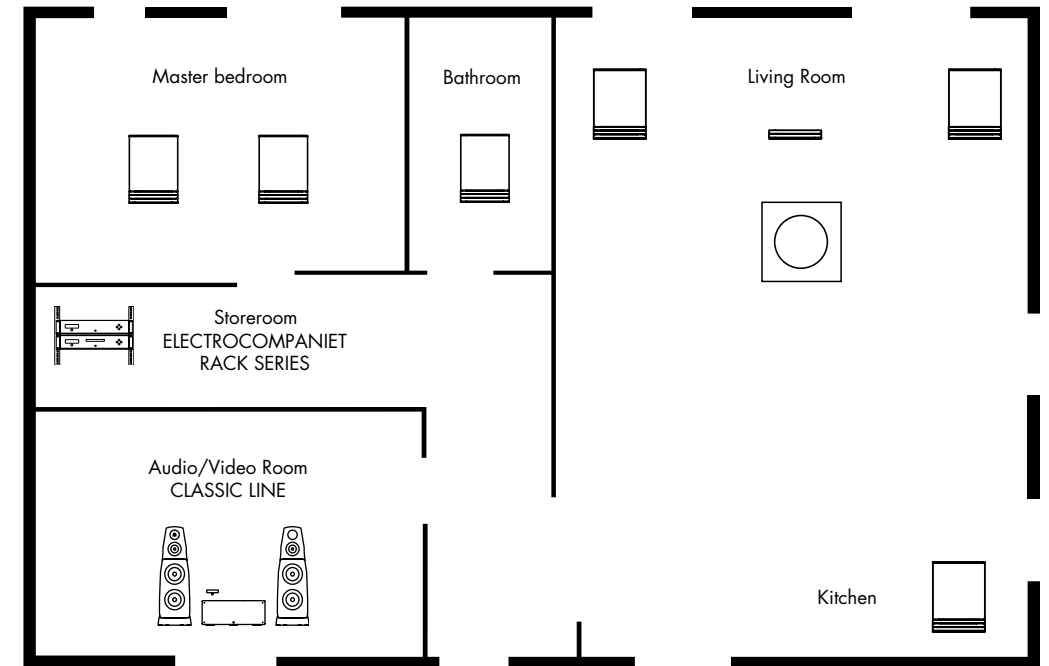

TECHNICAL SPECIFICATIONS



TANA SL-1 Streamer & Speaker	TANA L-1 Add-on Speaker	RENA S-1 Streamer	RENA SA-1 Streamer & Amplifier	SIRA L-1 Wireless Subwoofer
<p>AMPLIFIER & DAC</p> <ul style="list-style-type: none"> • 150 Watt Class A-B amp • DAC 192kHz/24bit • 32-bit floating-point DSP <p>CABINET</p> <ul style="list-style-type: none"> • Stiff aluminium enclosure • Two way bassreflex speaker <p>CONNECTIONS</p> <ul style="list-style-type: none"> • 1 x USB *external storage • 1x TOSlink input • 1x COAX input • 1x Gigabit Ethernet <p>WIRELESS CONNECTIONS</p> <ul style="list-style-type: none"> • Advanced 802.11 AC WiFi with MIMO • 96 kHz/24bit wireless speaker connection <p>STREAMING FEATURES:</p> <ul style="list-style-type: none"> • Airplay • Spotify Connect • TIDAL • WiMP • Qobuz • Internet Radio <p>SUPPORTED FORMATS:</p> <ul style="list-style-type: none"> • All popular formats including: WAV/WAVE, MP3, AAC+, Vorbis, AC3, DTS, ALAC, FLAC, APE, WMA, up to 192kHz/24bit, DSD, up to DSD 128 (5.6 MHz). <p>DIMENSIONS (H x W x D):</p> <ul style="list-style-type: none"> • 249 x 177 x 177 mm (9.8 x 6.98 x 6.98 inches) <p>Weight: 6 kg / 13.2 lbs</p>	<p>AMPLIFIER & DAC</p> <ul style="list-style-type: none"> • 150 Watt Class A-B amp • DAC 192kHz/24bit • 32-bit floating-point DSP <p>CABINET</p> <ul style="list-style-type: none"> • Stiff aluminium enclosure • Two way bassreflex speaker <p>WIRELESS CONNECTIONS</p> <ul style="list-style-type: none"> • 96 kHz/24bit wireless speaker connection <p>DIMENSIONS (H x W x D):</p> <ul style="list-style-type: none"> • 249 x 177 x 177 mm (9.8 x 6.98 x 6.98 inches) <p>Weight: 6 kg / 13.2 lbs</p>	<p>DAC</p> <ul style="list-style-type: none"> • 24bit/192kHz DAC • 32-bit floating-point DSP <p>CABINET</p> <ul style="list-style-type: none"> • Stiff aluminium enclosure <p>CONNECTIONS</p> <ul style="list-style-type: none"> • 1 x USB *external storage • 1x S/PDIF TOSLINK input • 1x S/PDIF COAX input • 1 x Gigabit Ethernet • 1 x Coaxial S/PDIF out • 1 x Stereo analog RCA out <p>WIRELESS CONNECTIONS</p> <ul style="list-style-type: none"> • Advanced 802.11 AC WiFi with MIMO • 96 kHz/24bit wireless speaker connection <p>STREAMING FEATURES:</p> <ul style="list-style-type: none"> • Airplay • Spotify Connect • TIDAL • WiMP • Qobuz • Internet Radio <p>SUPPORTED FORMATS:</p> <ul style="list-style-type: none"> • All popular formats including: WAV/WAVE, MP3, AAC+, Vorbis, AC3, DTS, ALAC, FLAC, APE, WMA, up to 192kHz/24bit, DSD, up to DSD 128 (5.6 MHz) <p>DIMENSIONS (H x W x D):</p> <ul style="list-style-type: none"> • 40 x 177 x 177 mm (1.57 x 6.98 x 6.98 inches) <p>Weight: 1 kg / 2.2 lbs</p>	<p>AMPLIFIER & DAC</p> <ul style="list-style-type: none"> • 2 x 75W CLASS D amp • 24bit/192kHz DAC • 32-bit floating-point DSP <p>CABINET</p> <ul style="list-style-type: none"> • Stiff aluminium enclosure <p>CONNECTIONS</p> <ul style="list-style-type: none"> • 1 x USB *external storage • 1x S/PDIF TOSLINK input • 1x S/PDIF COAX input • 1 x Gigabit Ethernet • 1 x Coaxial S/PDIF out • 1 x Stereo analog RCA out • 2 x Speaker terminals <p>WIRELESS CONNECTIONS</p> <ul style="list-style-type: none"> • Advanced 802.11 AC WiFi with MIMO • 96 kHz/24bit wireless speaker connection <p>STREAMING FEATURES:</p> <ul style="list-style-type: none"> • Airplay • Spotify Connect • TIDAL • WiMP • Qobuz • Internet Radio <p>SUPPORTED FORMATS:</p> <ul style="list-style-type: none"> • All popular formats including: WAV/WAVE, MP3, AAC+, Vorbis, AC3, DTS, ALAC, FLAC, APE, WMA, up to 192kHz/24bit, DSD, up to DSD 128 (5.6 MHz). <p>DIMENSIONS (H x W x D):</p> <ul style="list-style-type: none"> • 52 x 177 x 177 mm (9.6 x 6.98 x 6.98 inches) <p>Weight: 1,1 kg / 2.4 lbs</p>	<p>AMPLIFIER & POWER</p> <ul style="list-style-type: none"> • 200W CLASS D amp • Auto on/off universal input: 100-240V, 50-60Hz AC. <p>FREQUENCY RESPONSE</p> <ul style="list-style-type: none"> • 30-150Hz (-3dB) <p>ACOUSTIC DESIGN</p> <ul style="list-style-type: none"> • 7 inch High performance subwoofer • 2 x 7 inch vibration canceling passive radiators <p>ENCLOSURE</p> <ul style="list-style-type: none"> • Solid metal enclosure for zero cabinet rattle. • Changeable decorative speaker grills <p>WIRELESS CONNECTION</p> <ul style="list-style-type: none"> • 96 kHz/24bit wireless speaker connection <p>AUTO ADJUSTMENT</p> <ul style="list-style-type: none"> • Automatic sound integration with paired full range speakers. <p>DIMENSIONS (H x W x D):</p> <ul style="list-style-type: none"> • 257x 246 x 246mm (10.1x 9.6 x 9.6 inches) * Without optional stand <p>Weight: 12 kg / 26.45 lbs</p>

SUPPORTED PROTOCOLS

All audio streamers are fully wireless including the connection to Add-on speakers and/or subwoofers. They all support the protocols below:

Cloud:



- Airplay
- Tidal
- Spotify
- Qobuz
- Internet radio



TIDAL



Local/Network:

- SMB
- NFS
- USB storage
- UPnP, as renderer



Supported audio formats:

All popular formats including: WAV/WAVE, MP3, AAC+, Vorbis, AC3, DTS, ALAC, FLAC, APE, WMA, up to 192kHz/24bit, DSD, up to DSD 128 (5.6 MHz)

Supported control interfaces:

DLNA, UPnP, Webinterface, Android and iOS remote, Remote control, optional built-in control panel.

Control systems:

Integration with a major home automation systems. *Check web page for updated list.

*Specifications are subject to change without notice



ELECTROCOMPANIET

If music *really* matters™



Designed and produced in Norway

Norway, Head office: Tel. +47 51 74 10 23, sales@electrocompaniet.no

Germany, Electrocompaniet Europe GmbH: Tel. +49 228 92 39 42 91, info@electrocompaniet.de

USA, Electrocompaniet Distribution Inc.: Tel. +1 (669) 231-0100, sales@electrocompaniet.com

May 2017

www.ecliving.eu